



DuoClick™ Screw-Cap Culture Tubes

- New screw-cap! (Patent Pending)
- Aerobic culturing at first click
- Anaerobic culturing after second click
- Easy to open - Easy to close
- Printed graduations
- Flat, markable screw-cap

Two Position Screw Cap
Patent Pending



12 x 75mm

17 x 100mm

MTC Bio's new DuoClick™ tubes feature a unique, patent pending screw closure system. DuoClick tubes completely eliminate the excess force, splashing and general frustration of traditional snap-cap culture tubes. The advanced cap design includes two distinct positions for aerobic and anaerobic culturing (see flow-chart below). Just rotate the cap 1/4 turn to the first click to secure the cap in the aerobic position. Or, rotate it another 1/2 turn past the second click for a leakproof, airtight seal for anaerobic culturing.

DuoClick tubes are available gamma sterilized, with screw caps attached, and in our exclusive ready-to-use rack packaging.

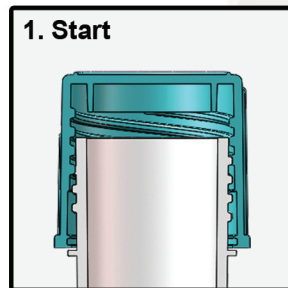

1. Start

Cap is supplied loosely on tube

Rotate 1/4 turn

First Click!

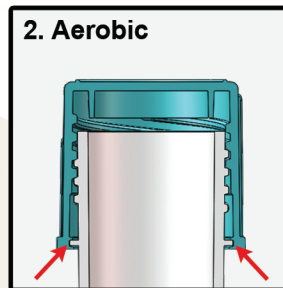

2. Aerobic

Cap is secure, but not airtight

Second Click!

Rotate 1/2 turn

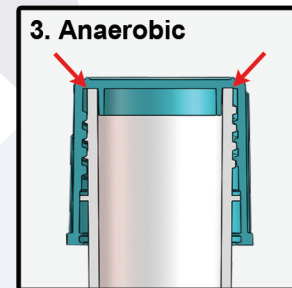

3. Anaerobic

Cap is airtight and leak-proof

Cat. No.	Description	Qty
12 x 75mm		
T8730	12 x 75mm, sterile, polypropylene, attached cap, 20 bags of 25 tubes	500
T8732	12 x 75mm, sterile, polypropylene, attached cap, 10 foam racks of 50 tubes	500
T8734	12 x 75mm, sterile, polypropylene, attached cap, individually wrapped	500
T8741	12 x 75mm, sterile, polystyrene, attached cap, 8 bags of 125 tubes	1000
T8742	12 x 75mm, sterile, polystyrene, attached cap, 10 foam racks of 50 tubes	500
T8750	12 x 75mm, non-sterile, polypropylene, bulk-pack, non-graduated, tubes and caps packed separately	1000
17 x 100mm		
T8830	17 x 100mm, sterile, polypropylene, attached cap, 20 bags of 25 tubes	500
T8832	17 x 100mm, sterile, polypropylene, attached cap, 10 foam racks of 50 tubes	500
T8834	17 x 100mm, sterile, polypropylene, attached cap, individually wrapped	500
T8840	17 x 100mm, sterile, polystyrene, attached cap, 20 bags of 25 tubes	500
T8842	17 x 100mm, sterile, polystyrene, attached cap, 10 foam racks of 50 tubes	500
T8850	17 x 100mm, non-sterile, polypropylene, bulk-pack, non-graduated, tubes and caps packed separately	1000