

# Acura® dilute 1:10 dilution pipette

# 1:10 dilution pipette

Air displacement pipette with two pre-calibrated steps allows subsequent pipetting of 1 and 0.1 mL of the same liquid. Metal nozzle fits long straw tips to aspirate from narrow or deep reservoirs (i.e. Stomacher® bags). Ideal alternative to the graduated glass pipettes when performing serial 1:10 dilutions in bacteriology. Three-year warranty.

## 810

1 + 0.1 mL

### The Acura® dilute 810

#### Product advantages

- Two pre-calibrated fixed volumes – no setting required
- Smooth activation, excellent ergonomics
- Interchangeable PE nozzle protection filter
- Justip™ system\* for height adjustment of tip ejector
- Independent calibration for each volume
- Easy maintenance, cleaning and disinfection
- Fully autoclavable at 121°C / 250°F

\* Socorex patented

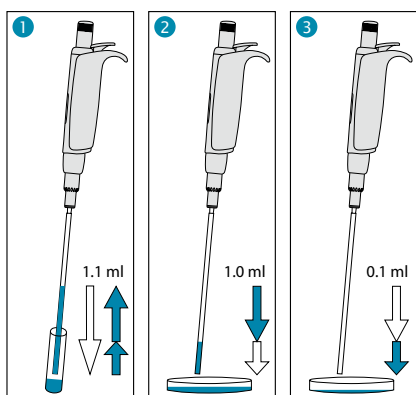

#### Simple operation

- 1 Depress plunger button in full, then release slowly to aspirate 1.1 mL
- 2 Depress plunger button to first stop, thus dispensing 1 mL in Petri dish
- 3 Depress plunger button to second stop, thus dispensing residual 0.1 mL in next Petri dish



#### No setting required ①

Two fixed volumes within one plunger travel.



#### Innovative dual calibration ②

Both volumes of 1 mL and 0.1 mL can be calibrated independently from each other. Calibration switch protected by seal sticker.



#### Justip™ ejector ③

Turn left or right to adjust ejector to straw tip position on the nozzle.



#### Straw tips ④

First class polypropylene. Size 190 mm. Specially designed for narrow vials and Stomacher® bags. Large diameter (4mm) prevents blocking by particles in suspension.

#### Performance and ordering information - Instrument

Volume	Inaccuracy (E%)	Imprecision (CV%)	Cat. No.
1 mL	≤± 0.5 %	< 0.4 %	810.1100
0.1 mL	≤± 2.0 %	< 2.5 %	

Performance values obtained with bidest. water at constant temperature (± 0.5°C) comprised between 20 and 25°C in accordance with ISO 8655.

#### Ordering information - Accessories

Description	Packaging	Cat. No.
Straw tips, polypropylene, sterilized (L: 190 mm, Ø: 4 mm)	40x 25 / pk	313.1119.40
Nozzle protection filter, PE material	100 / pk	322.810
Work station 340 for 3 pipettes	1 / pk	320.340
Shelf pipette holder 332 for 2 pipettes	1 / pk	320.332
Shelf pipette holder 332 for 2 pipettes	4 / pk	320.332.4

# Qualitix® pasteurs, straws and filters



## Glass Pasteur pipette ①②

Standard Pasteur models fitting 2 and 5 mL Acura® *manual / electro* and Calibra® macropipettes with their respective adapters. Useful alternative to macrotips, for instance when handling PP affecting reagents. Model and size selection fit most lab requirements.

## Pasteur pipette adapters ③

Dedicated PVDF adapters with two internal O-rings tightly fitting glass Pasteur pipette (ext Ø 6.5 - 7.2 mm), without excluding the use of regular PP tips.

## Ordering information - Pasteur pipettes

Material	Volume	Dimensions (l x Ø mm)	Packaging	Cat. No.
Glass	2 mL	150 x 7	250 / pk	313.02.150
Glass	2 mL	230 x 7	250 / pk	313.02.230
Glass with cotton plug	2 mL	150 x 7	250 / pk	313.02.150C
Glass with cotton plug	2 mL	230 x 7	250 / pk	313.02.230C

## Ordering information - Pasteur adapters

Fits macropipette	Packaging	Cat. No.
Acura® <i>manual</i> 835, 2 mL Acura® <i>electro</i> 936, 2 mL Calibra® <i>digital</i> 832, 2 mL	1 / pk	1.835.631
Acura® <i>manual</i> 835, 5 mL Acura® <i>electro</i> 936, 5 mL	1 / pk	1.835.633



## Straw tips ④

Fitting the Acura® *dilute* 810 pipette. The long and thin straw tips allow pick-up of particle containing liquids in Stomacher® bags and deep, narrow reservoirs. Supplied sterilized in re-sealable bag.

## Nozzle filters for pipettes ⑤⑥

Protection against liquid overflow or aerosol contamination. Filters are interchangeable, non-sterile, non autoclavable.

## Ordering information - Straw tips and nozzle filters

Description	Fits	Material	Size (l x Ø mm)	Packaging	Cat. No.
Straw tips, 1.1 mL	Acura® <i>dilute</i> 810	PP, sterilized	190 x 4	40x 25 / pk	313.1119.40
Nozzle filter	Acura® <i>dilute</i> 810	PE	6.3 x 2.5	100 / pk	322.810
Nozzle filter	Calibra® <i>digital</i> 832, 2 mL	Cellulose	22 x 7	250 / bag	322.02
Nozzle filter	Acura® <i>manual</i> 835, 2 and 5 mL Acura® <i>electro</i> 936, 2 and 5 mL	PP fiber	20 x 7.5	250 / bag	322.05
Nozzle filter	Calibra® <i>digital</i> 832, 10 mL Acura® <i>manual</i> 835, 10 mL Acura® <i>electro</i> 936, 10 mL	PP fiber	30 x 10.5	100/ bag	322.10